



GMLighting®

18700 Ridgeland Ave.
Tinley Park, IL 60477

Technical Info:
tech@gmlighting.net



Adding Google Home™ Commands to LUXcontrol

1

Log Onto LUXcontrol™. Find your LUXcontrol icon on your smart phone and open the LUXcontrol app. Sign in.

2

Grant Permissions. Granting our app access to data does not put your personal information at risk, but it does enable us to better serve you through apps like Google Home™.

3

You're Home. Your 'My Home' window shows all data that you've granted permissions to show, and the GM fixtures that you've connected to LUX. **Let's hook up Google Home™!**

4

Time to Choose. You can have Google Home™ control any fixture or group that you have connected to LUX. Let's choose this outlet that's at the front door. Click it.

5

Advance to Pairing With Google Home™. Tap the three dots in the upper right corner of your screen.

6

Find the Google Assistant Icon. On this device info screen, you'll find their logo under Third Party Control (if you are not on this page, look for the 3 dots at the top of previous page). Go ahead and tap it.

7

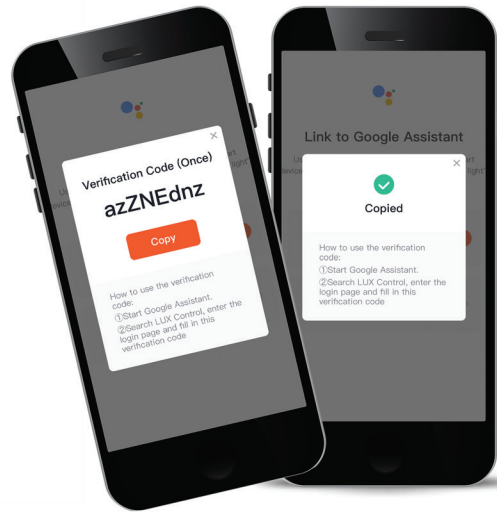

Verification Code. Click Link with Verification Code to get a code that you will use with the Google Assistant app. Make sure that you get the Copied Successfully

8



Open Google Home App. Once you have opened the app press the plus icon in the top right corner of the screen (its small, you might miss it).

9

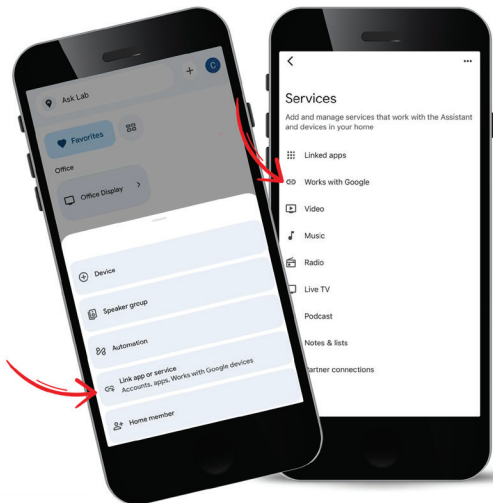

Getting Close! After pressing the plus icon in the top right corner of the screen, select the "Link app or service". On the next Services page select the "Works with Google" option.

10

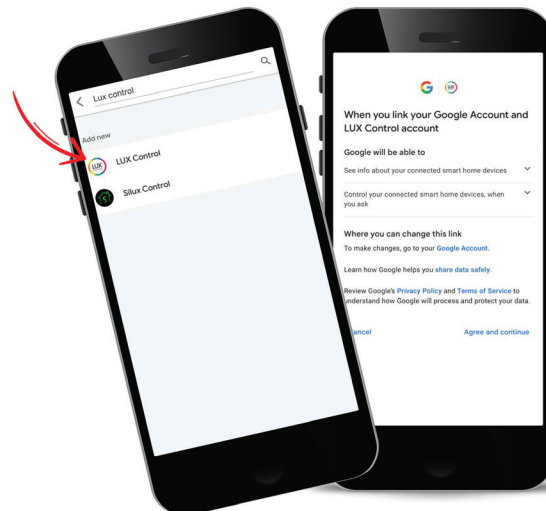

Activate Your Fixture. In the "Works with Google" tab proceed to search "Lux Control" in the tab. Afterwards press "Continue" and then "Agree and continue". At this point enter the code that was copied from the Lux App, and select the devices you would like to control.