

WARNING!

FAMILIARIZE YOURSELF WITH INSTRUCTIONS BEFORE PROCEEDING. FOLLOW ALL LOCAL CODES. VERIFY THAT POWER IS OFF BEFORE PROCEEDING. MAKE SURE YOU USE PROPER RATED WIRE.

NOTE: WE RECOMMEND THAT YOU ENGAGE A QUALIFIED, LICENSED ELECTRICIAN. MODIFYING OR DISASSEMBLING BEYOND INSTRUCTIONS WILL VOID THE WARRANTY FOR THIS PRODUCT.

DO NOT EXCEED MAXIMUM RUN OF 40' OF LIGHT FIXTURE FROM ONE 120V POWER LEAD. TURN OFF POWER GOING TO JUNCTION BOX OR FIXTURE BEFORE CONNECTING. MAKE SURE ALL CONNECTIONS ARE COMPLETE BEFORE POWERING UP.

Layout Covalinear Lightbars and Connectors

Layout the bars that you wish to connect together, making sure to verify the free open space available under the cabinet, i.e. a 24" cabinet equals about 23" of actual mountable space. Determine where you will be bringing power in, and mount a CLQB junction box (recommended) - or wire a CL6-PCHW to power and plug into first lightbar in your run. Fig. 1.

Connecting Fixture Leads to 120V Power

Plug-In: Connect CL6-PC lightbar to power supply connectors to 120V wall outlet. Just plug it in. To hardwire into 120V power, use CL6-PCHW and connect. Fig. 2. The other end plugs into modular connector of first or only Covalinear fixture in your run. Pry off connector cover with flat head screwdriver and plug power connector into fixture. Discard cover, Fig. 3.

Attach Covalinear Mounting Clips

Screw aluminum mounting clips (2 comes with each lightbar - standard or 45° angle mount) to surface of mounting area. These spring loaded clips will hold Covalinear securely to surface. Fig. 4.

Connect Covalinear Lightbars and Mount

Refer to diagram and interconnect Covalinear lightbars if needed, using CL series connectors. Fig. 5. Once all are mounted, power up.

Select Color Temp.

The color temp. selector switch enables a choice between 3 color temperatures: 2700K, 3000K and 3500K. Simply adjust switch to the color temp. desired. Fig. 6.

Covalinear™ 120V Switchable White Linear LED Lightbar

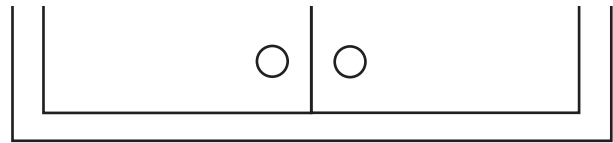

Cabinet Front Elevation

Fig. 1

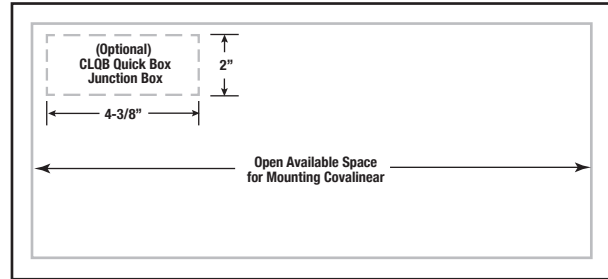

Under Cabinet

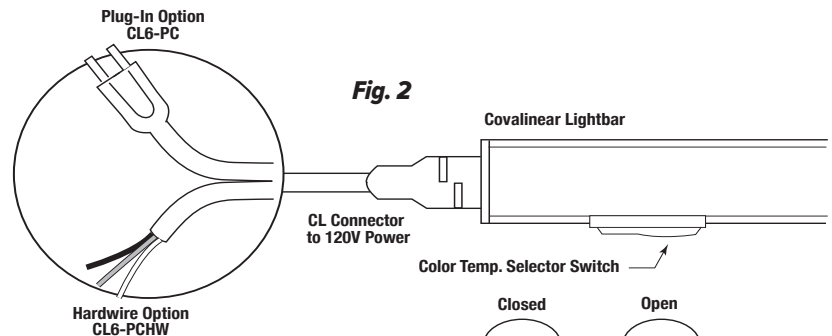

Fig. 2

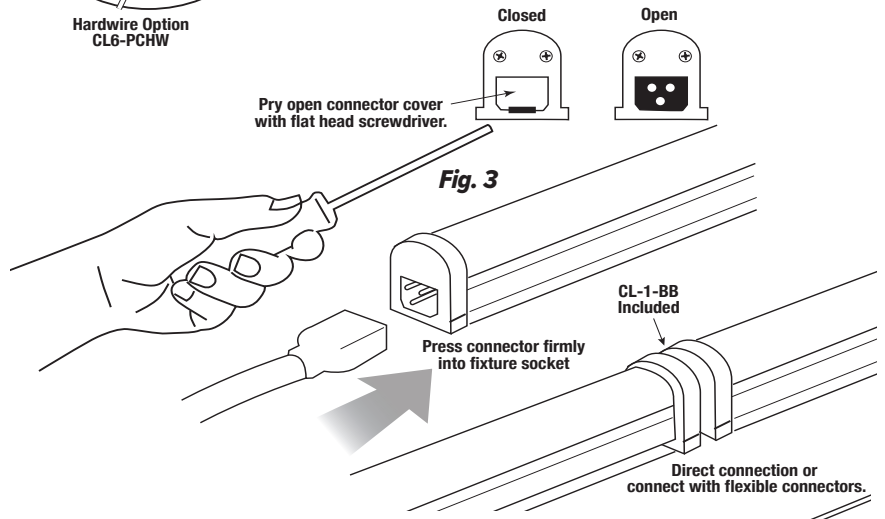

Fig. 3

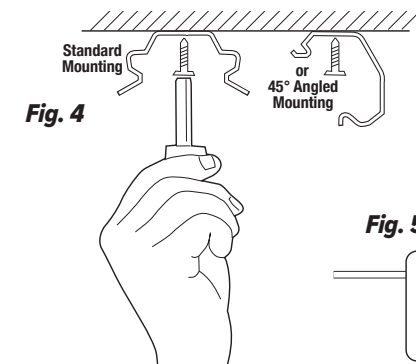

Fig. 4

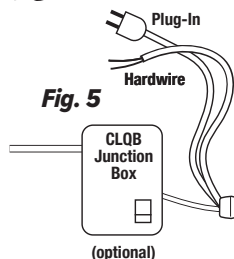

Fig. 5

Fig. 6

