



GMLighting®

18700 Ridgeland Ave.
Tinley Park, IL 60477

Technical Info:
tech@gmlighting.net



1

Log Onto LUXcontrol™. Find your LUXcontrol icon on your smart phone and open the LUXcontrol app. Sign in.

2

Grant Permissions. Granting our app access to data does not put your personal information at risk, but it does enable us to better serve you through apps like Google Home™.

3

You're Home. Your 'My Home' window shows all data that you've granted permissions to show, and the GM fixtures that you've connected to LUX. **Let's hook up Google Home™!**

4

Time to Choose. You can have Google Home™ control any fixture or group that you have connected to LUX. Let's choose this outlet that's at the front door. Click it.

5

Advance to Pairing With Google Home™. Tap the three dots in the upper right corner of your screen.

6

Find the Google Assistant Icon. On this device info screen, you'll find their logo under Third Party Control (if you are not on this page, look for the 3 dots at the top of previous page). Go ahead and tap it.

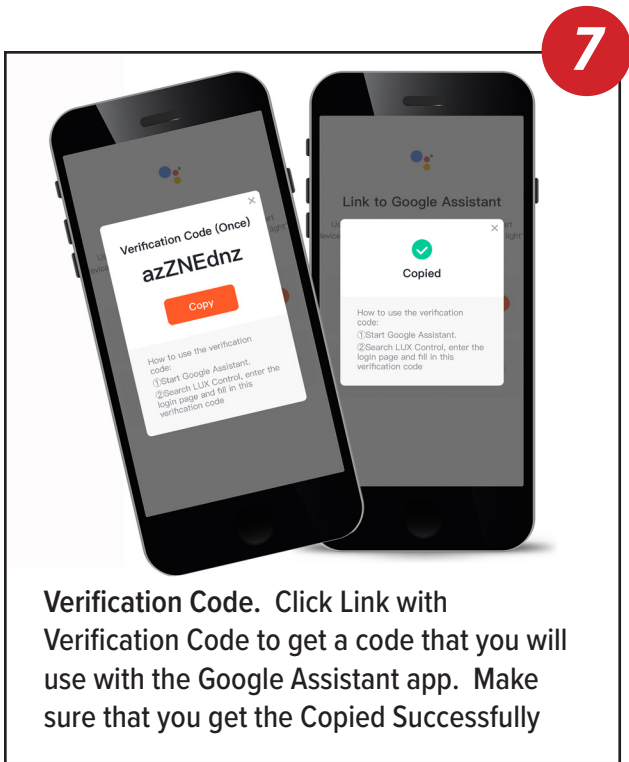

Verification Code. Click Link with Verification Code to get a code that you will use with the Google Assistant app. Make sure that you get the Copied Successfully

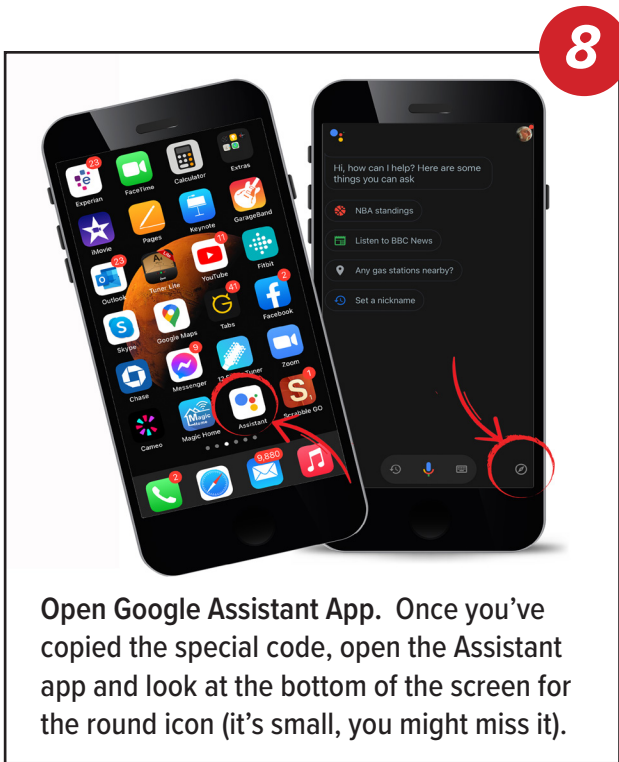

Open Google Assistant App. Once you've copied the special code, open the Assistant app and look at the bottom of the screen for the round icon (it's small, you might miss it).

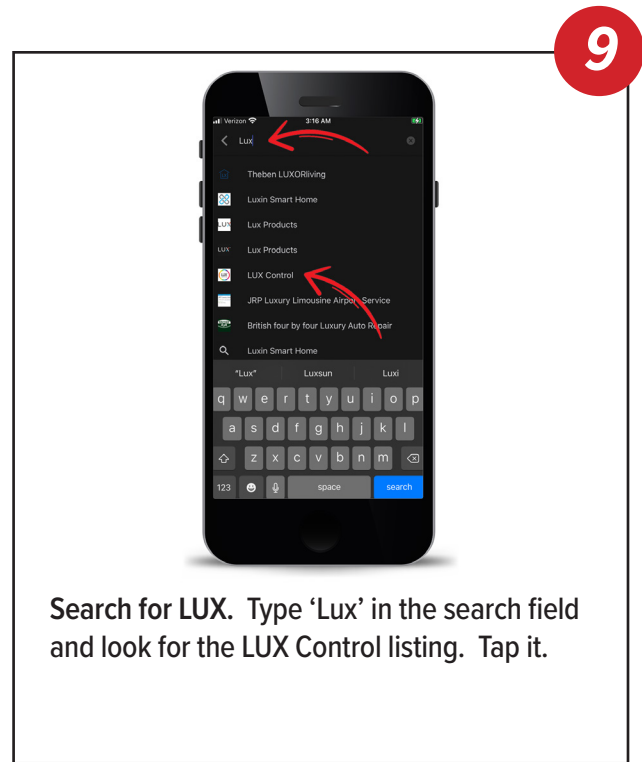

Search for LUX. Type 'Lux' in the search field and look for the LUX Control listing. Tap it.

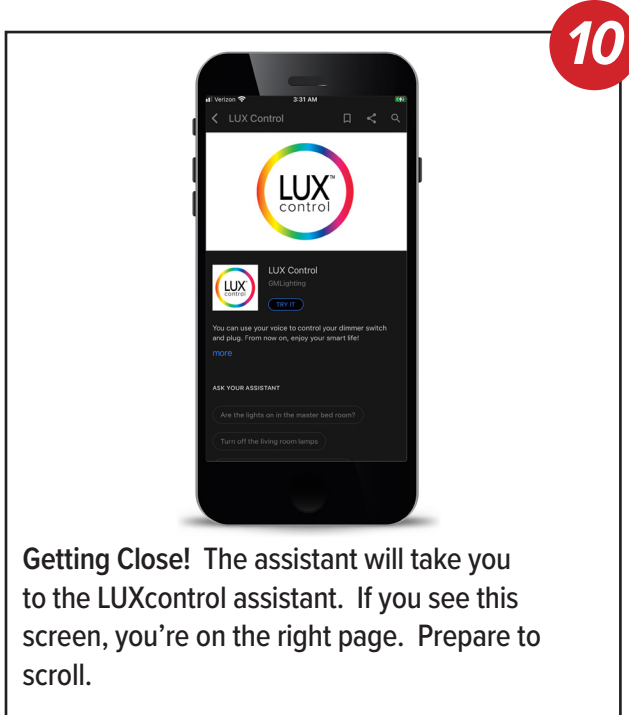

Getting Close! The assistant will take you to the LUXcontrol assistant. If you see this screen, you're on the right page. Prepare to scroll.

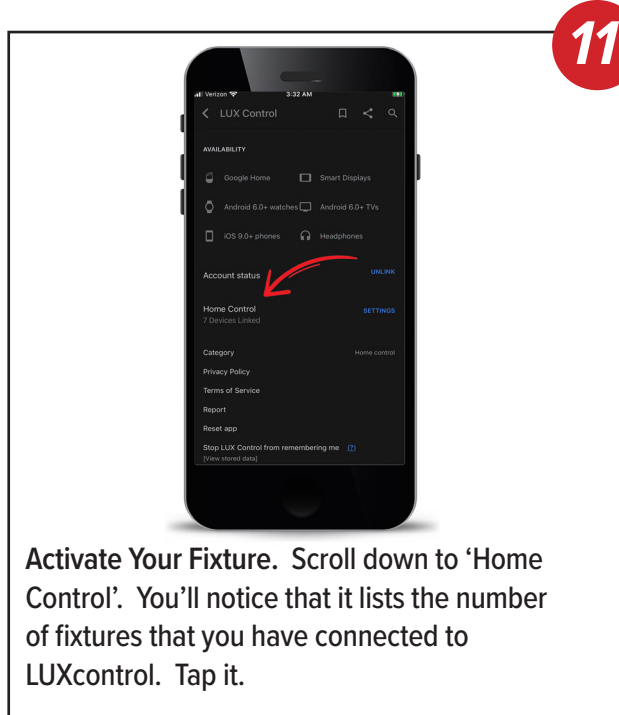

Activate Your Fixture. Scroll down to 'Home Control'. You'll notice that it lists the number of fixtures that you have connected to LUXcontrol. Tap it.

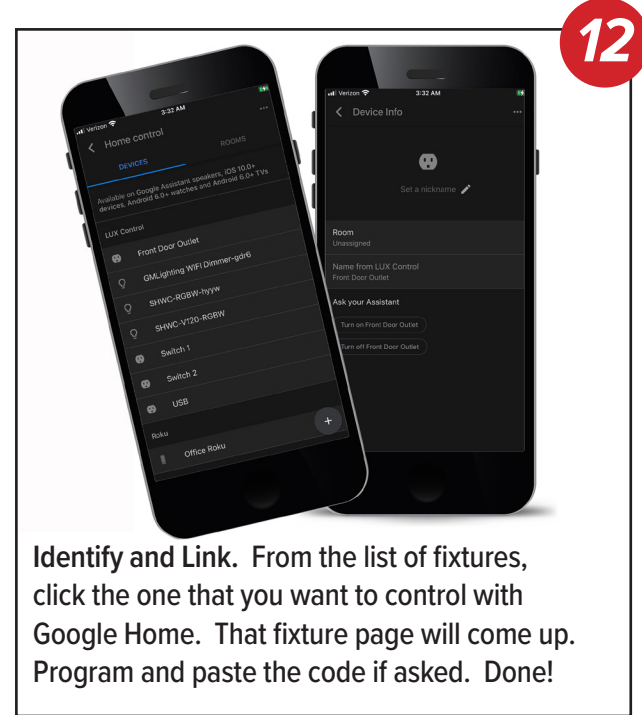

Identify and Link. From the list of fixtures, click the one that you want to control with Google Home. That fixture page will come up. Program and paste the code if asked. Done!